

TYP. PIPE FIXING TO CONCRETE SUPPORT DETAIL
SCALE 1:25

- NOTE:
- SUPPORT ARRANGEMENTS, JOINING, ANCHORS, GUIDES, CLAMPS AND SUPPORT SPACING TO PIPE SUPPLIER SPECIFICATION.
 - CONTRACTOR TO CONFIRM WITH PIPE SUPPLIER PRIOR CONSTRUCTION AND INSTALLATION COMMENCEMENT.

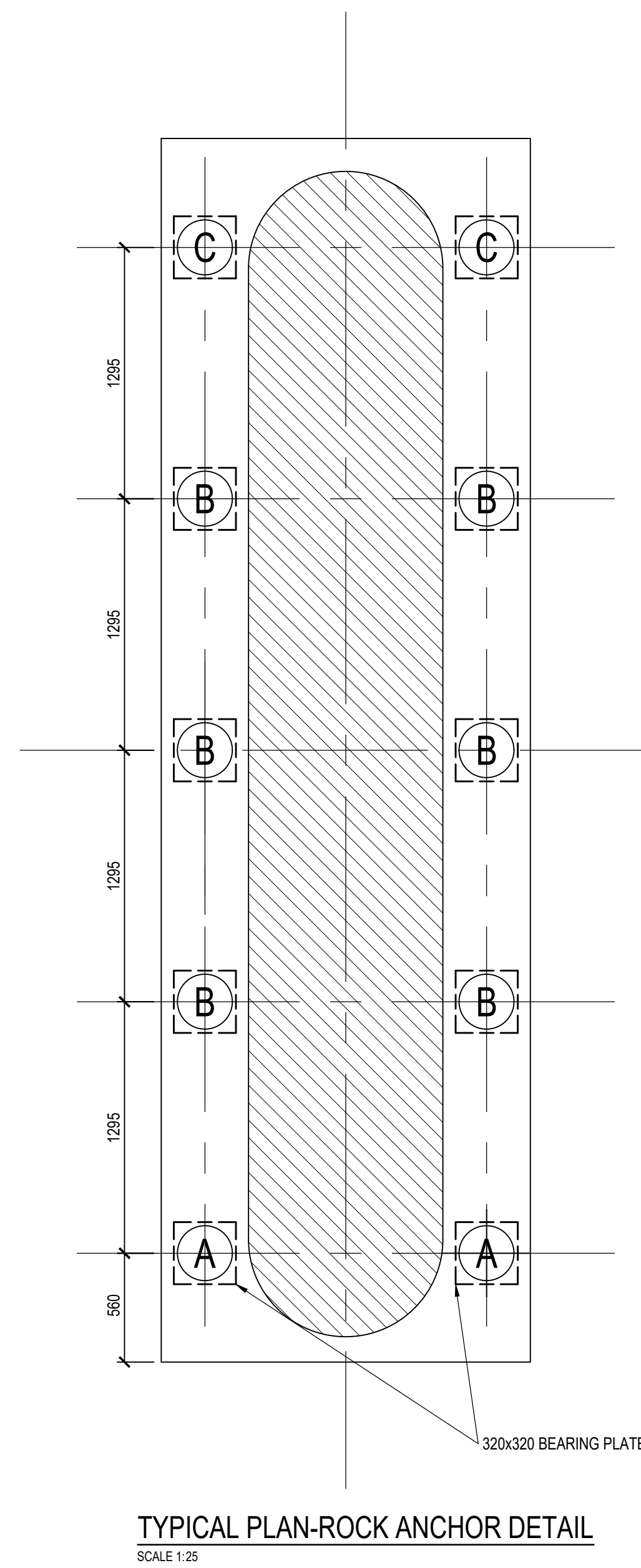

REF.	LOADS (KN)	
	WORKING	ULTIMATE
A	950	1550
B	750	1250
C	400	650

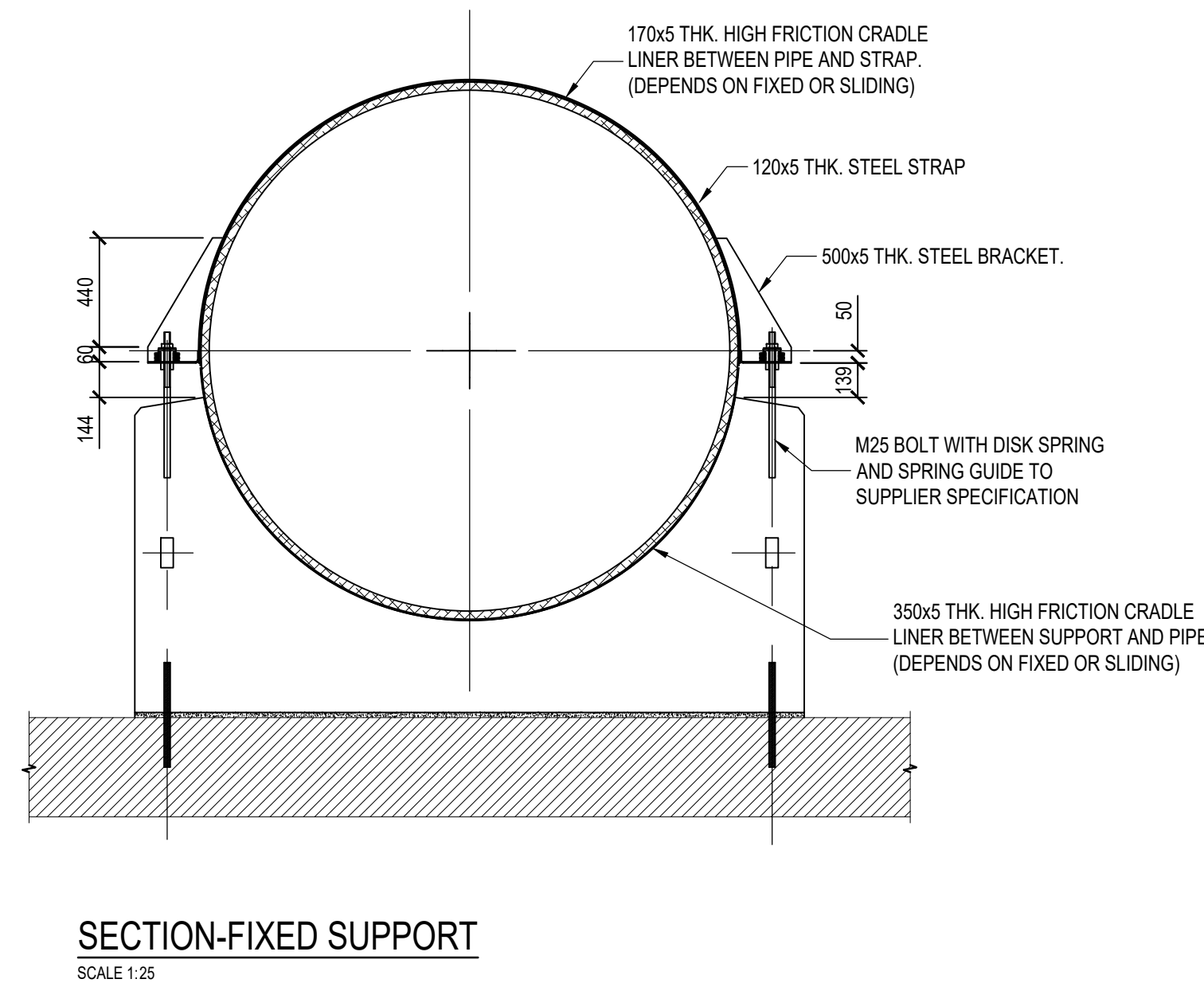
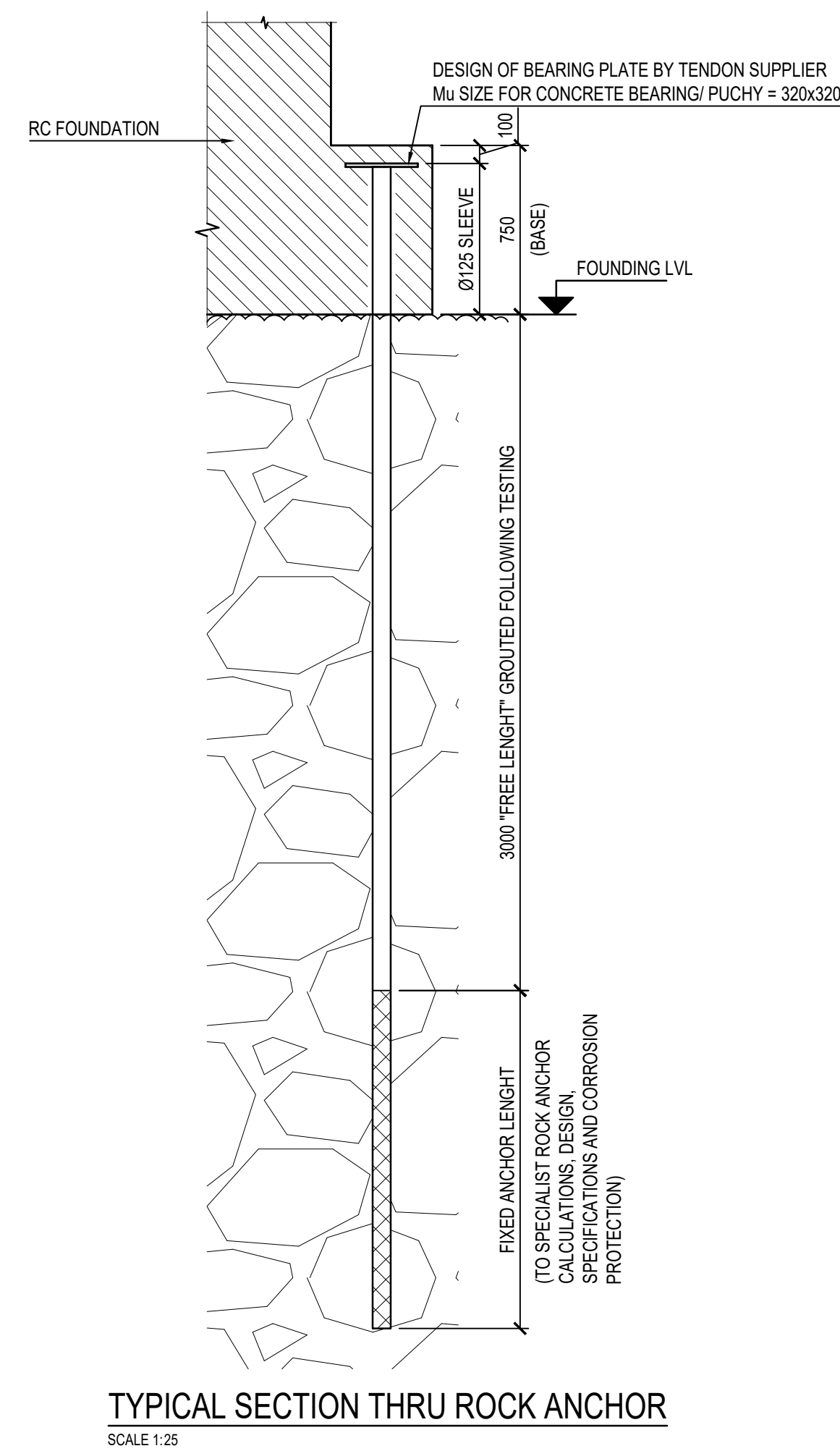

- NOTES:
- PROVING TESTS SHALL BE CARRIED OUT IN LINE WITH THE SAIC COP LATERAL SUPPORT IN DEEP EXCAVATIONS (1993).
 - A MINIMUM OF 3 TESTS SHOULD BE CONDUCTED PER BASE ONE FOR EACH TYPE (A,B,C).
 - A DETAILED METHOD STATEMENT SHOULD BE SUBMITTED BY THE CONTRACTOR AND APPROVED BY THE ENGINEER.

- NOTES: REINFORCED CONCRETE
- THE APPLICABLE STANDARD SPECIFICATION IS SANS 12005 - 1982 WHICH SHOULD BE READ IN CONJUNCTION WITH THE VARIATIONS AND ADDITIONS CONTAINED IN THEMBA PROJECT SPECIFICATION FOR CONCRETE (STRUCTURAL).
 - CONCRETE COVER TO REINFORCEMENT AND CONCRETE STRENGTH TO BE AS INDICATED BELOW. COVER IS GIVEN TO THE NEAREST FACE. MINIMUM BAR COVER TO BE MAXIMUM OF BAR DIAMETER AND AS SHOWN BELOW. SPECIFIED COVER TO BE MAINTAINED USING CEMENT MORTAR COVER BLOCKS OR APPROVED PLASTIC SPACERS.
 - ALL AGGREGATE TO BE 19mm UNLESS OTHERWISE SPECIFIED.
 - CONCRETE DESIGN MIXES TO BE SUBMITTED TO ENGINEER FOR COMMENTS PRIOR TO CONSTRUCTION.
 - CUBE TESTS TO BE CARRIED OUT ON SITE AND LOGGED WITH POSITION AND DATE. CUBES TO BE TAKEN FOR EACH TYPE OF ELEMENT, AT LEAST ONE SET DAILY AND AT LEAST ONE SET EVERY 50m.
 - REINFORCEMENT TO BE IN ACCORDANCE WITH SANS 820 AND SHALL BE BENT IN ACCORDANCE WITH SANS 82.
 - ALL CAST IN ITEMS SHALL BE FREE OF OIL, GREASE, DIRT OR ANY OTHER MATERIAL WHICH MAY IMPAIR THE BOND WITH THE CONCRETE. CONTRACTOR TO REFER TO ARCHITECT/SPECIALIST DRAWINGS FOR DETAILS POSITIONS OF OPENINGS, SLEEVES, CONDUITING, ETC. FOR STORMWATER, SEWERAGE AND OTHER SERVICES.
 - FOUNDATIONS HAVE BEEN DESIGNED FOR AN ALLOWABLE GROUND BEARING CAPACITY OF 1000 kPa.
 - ALL FOUNDATION EXCAVATIONS TO BE INSPECTED BY THE GEOTECHNICAL ENGINEER PRIOR TO CONCRETING.
 - REMOVAL OF FORMWORK TO BE IN ACCORDANCE WITH THE PROJECT SPECIFICATION. IT IS THE CONTRACTOR'S RESPONSIBILITY FOR BACK-PROPPING ON MULTI-STORY SLAB CONSTRUCTION.
 - ALL EXPOSED CORNERS TO BE CHAMFERED 25x25 O.U.N.

ELEMENT	CONCRETE STRENGTH AT 28 DAYS (MPa)	COVER mm
FOUNDATIONS	30	50
COLUMNS	30	45
BEAMS	30	45
SLABS	30	45
WALLS	30	45
-	40	30

themba
Confidence • Trust •
INFRASTRUCTURE CONSULTING
Tel: 0861themba (843633)
email: info@themba-africa.com

CLIENT
JOHANNESBURG WATER
TURBINE HACC
62 NTEMI PICISO STREET
NEW TOWN



TURBINE HACC
62 NTEMI PICISO STREET
NEWTOWN

TEL: (011) 688-1400
FAX: (011) 688-1521

Joburg

DIEPSLOOT SEWAGE AQUEDUCT
BRIDGE 3

SECTIONS AND DETAILS

SURVEY INFORMATION				APPROVAL BY JW DEPOT		SCALE	AMENDMENTS	
PROJECT SURVEYOR:		CHECKED				AS SHOWN	REV:	DESCRIPTION
DATE:		APPROVED BY:				A	ISSUED FOR TENDER	30/09/2024
CCTV INFORMATION		SIGNATURE		DATE				
CCTV COMPANY:		APPROVAL BY JW PLANNING						
DATE:		CHECKED						
		APPROVED BY:						
		SIGNATURE		DATE				

CONSULTANTS DWG NO
13247-02/S/010/A

DRAWING No.

JW14455

PROJECT No. DRAWING No. REV.

A0 SHEET 3 OF 4

ORIGINAL PAGE SIZE

FILE No.